



# Guildhall Road

Town Centre, Northampton

oriordanbond  
SALES & LETTINGS



GROUND FLOOR  
716 sq.ft. (66.5 sq.m.) approx.

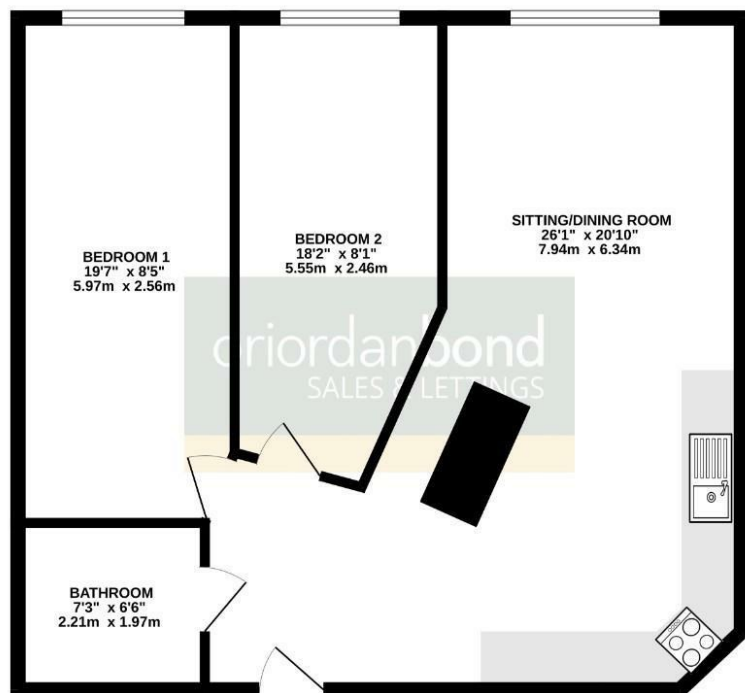

TOTAL FLOOR AREA: 716 sq.ft. (66.5 sq.m.) approx.  
Whilst every attempt has been made to ensure the accuracy of the floorplan contained here, measurements of doors, windows, rooms and any other items are approximate and no responsibility is taken for any error, omission or misstatement. This plan is for illustrative purposes only and should be used as such by any prospective purchaser. The services, systems and appliances shown have not been tested and no guarantee as to their operability or efficiency can be given.  
Made with Metagor C2024

## Guildhall Road

Town Centre

NN1 1AG

OFFERS OVER £125,000

This fabulous two double bedroom second floor apartment is offered for sale in Northampton's popular Cultural Quarter and located in an iconic art deco building on Guildhall Road, just a few doors away from the famous Royal and Derngate Theatre.

Offered with no onward chain, the accommodation comprises main entrance with spiral stairway and lifts to all floors, central entrance hall with access to all accommodation, spacious open plan living/dining room and fitted kitchen with built-in appliances, two double bedrooms and bathroom. Benefits include secondary double glazing and gas radiator heating. (B/716/-)

Leasehold Information: Lease Remaining - 981 years (as of 2025) / Ground Rent & Service Charge - £269.16 pcm

### Additional information

- Council Tax Band: C
- Energy Efficiency Rating: C

### Viewing

Viewing strictly by appointment – details below

### Disclaimer

O'Riordan Bond Estate Agents Limited has not tested apparatus, equipment, fittings or services and so cannot verify they are in working order. The buyer is advised to obtain verification from their solicitor or surveyor.

O'Riordan Bond Far Cotton Sales

01604 706007

farcotton@oriordanbond.co.uk

